

ASN28

Partial extension consisting of a guide rail and a slider. This compact size and simple design allow very high load capacities. The high system rigidity is formed in connection with the adjacent construction.

Special strokes are defined as deviations from standard stroke H. They are each available as multiples of the values in the table below. These values are dependent on the spacing of the ballcage. See Stroke modification in table.

Dimensions in mm



Variant Data

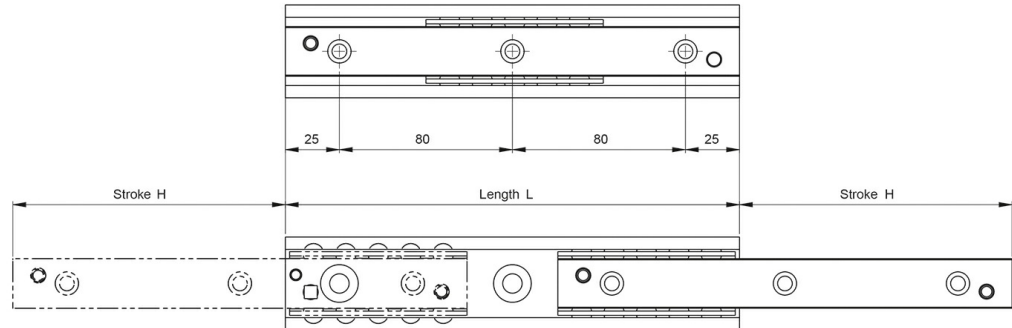
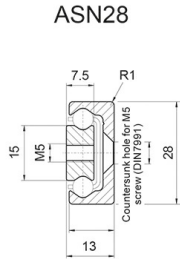

Designation	Length	Stroke	System Load Capacity Radial	System Load Capacity Axial	Number of Fixing Holes	Stroke Modification	Weight
ASN28-130	130	74	613 N	429 N	2	9,50	2,02 kg/m
ASN28-210	210	116	1116 N	781 N	3	9,50	2,02 kg/m
ASN28-290	290	148	1934 N	1354 N	4	9,50	2,02 kg/m
ASN28-370	370	190	2445 N	1711 N	5	9,50	2,02 kg/m
ASN28-450	450	232	2955 N	2069 N	6	9,50	2,02 kg/m
ASN28-530	530	274	3466 N	2426 N	7	9,50	2,02 kg/m
ASN28-610	610	316	3976 N	2783 N	8	9,50	2,02 kg/m
ASN28-690	690	358	4487 N	3141 N	9	9,50	2,02 kg/m
ASN28-770	770	400	4997 N	3498 N	10	9,50	2,02 kg/m
ASN28-850	850	433	5828 N	4080 N	11	9,50	2,02 kg/m
ASN28-930	930	475	6338 N	4436 N	12	9,50	2,02 kg/m

Variant Data

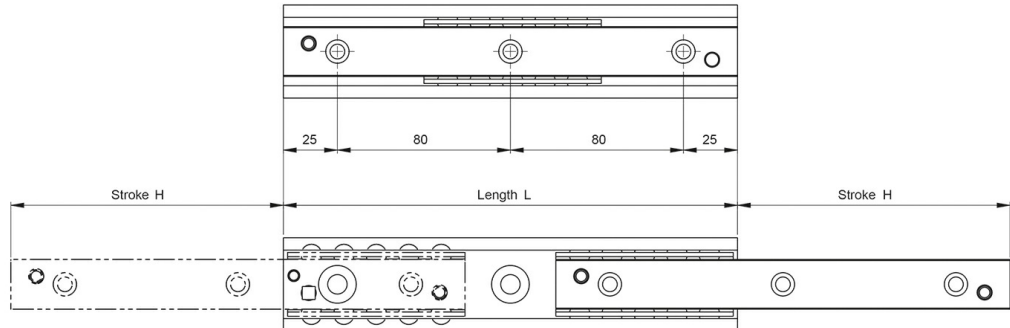
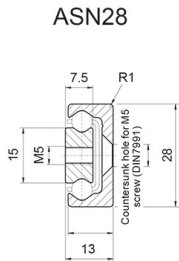

Designation	Length	Stroke	System Load Capacity Radial	System Load Capacity Axial	Number of Fixing Holes	Stroke Modification	Weight
ASN28-1010	1 010	517	6848 N	4793 N	13	9,50	2,02 kg/m
ASN28-1090	1 090	559	7358 N	5150 N	14	9,50	2,02 kg/m
ASN28-1170	1 170	601	7868 N	5507 N	15	9,50	2,02 kg/m

Variant Measurements

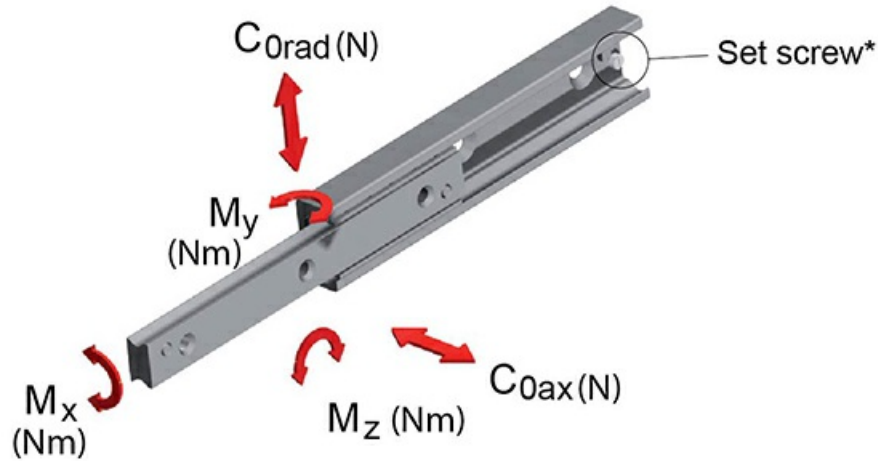

* Remove the set screw to reach all the fixing holes and for double stroke.

Designation	Mx moment (Nm)	My moment (Nm)	Mz moment (Nm)
ASN28-130	15,30	20	28
ASN28-210	26,10	57	82
ASN28-290	39,60	132	188
ASN28-370	50,40	213	305
ASN28-450	61,20	314	449
ASN28-530	72	435	621
ASN28-610	82,80	575	821
ASN28-690	93,60	735	1 050
ASN28-770	104,40	914	1 306
ASN28-850	117,90	1 165	1 665
ASN28-930	128,70	1 389	1 984
ASN28-1010	139,50	1 613	2 330
ASN28-1090	150,30	1 894	2 705
ASN28-1170	161,10	2 175	3 108