

Joint 40x80

Joint with adjustable friction. Creates an articulated link between two profiles or surface elements. Use the screw to infinitely vary the joint's friction resistance or to fasten the joint at a defined position.

Note: On-site mount.

Material: Aluminium coloured die-cast zinc

System: 40 - Slot 8

Type: Joints



General Data

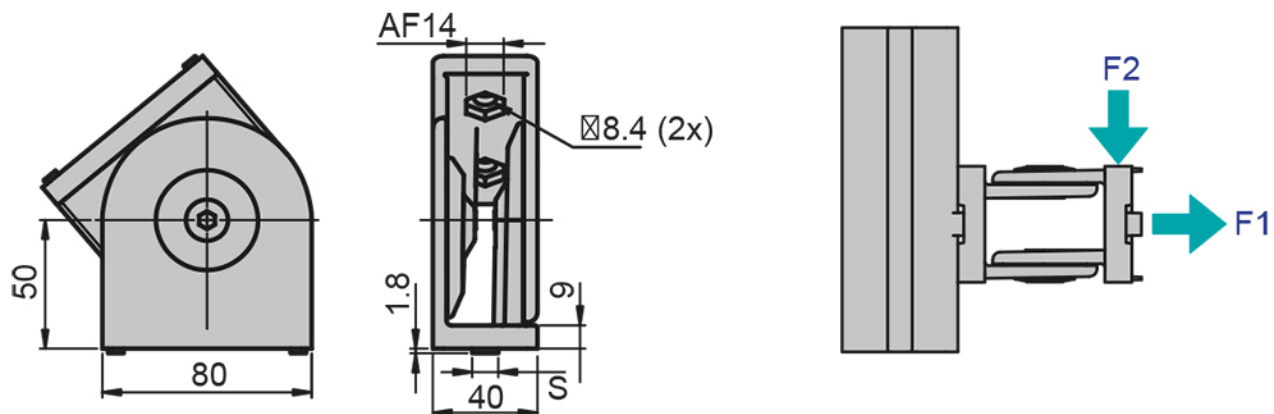

Designation	System	F1 (N)	F2 (N)
PZ1317	40 - Slot 8	15000	1000