

Turntable Sets

Application:

The turntable set forms an ideal unit for creating swivel arms for monitors, control desks, etc. The turntable set 80 is installed in a section of profile 80 x 80 round, 120 mm long, and is supplied complete.

System: 40 - Slot 8

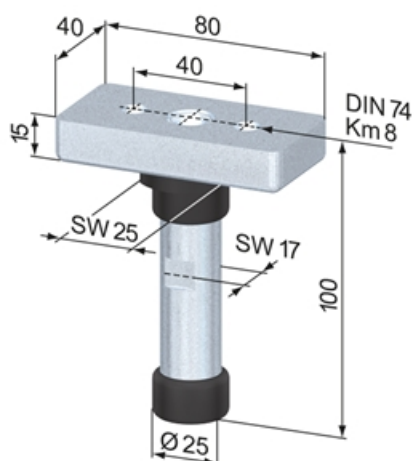

SA5220N

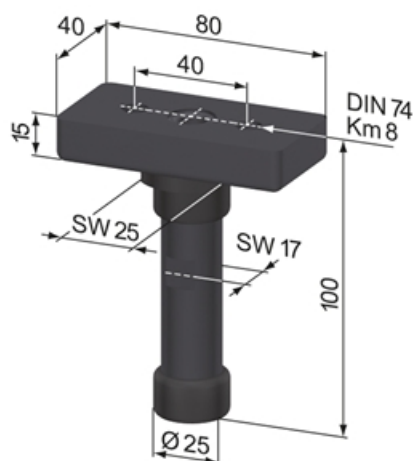

SA5220S

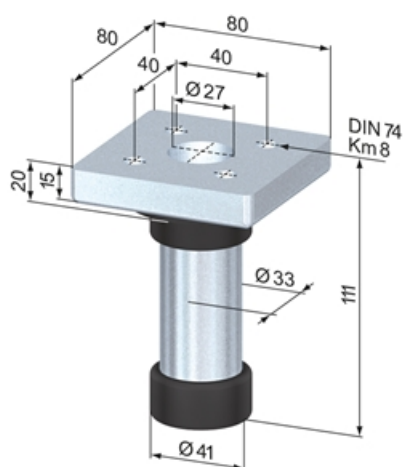

SA5210N

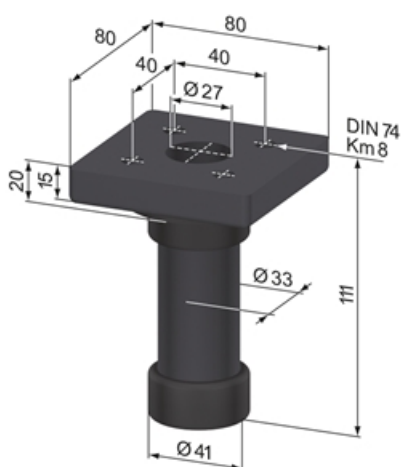

SA5210S

Turntable Sets

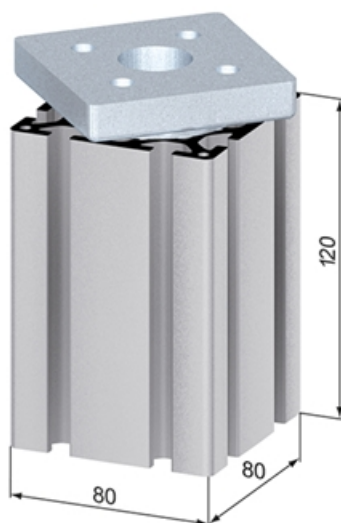

General Data

| Designation | Description | Material | Weight (g) |
|----------------|---------------------------|--------------------------------------|------------|
| SA5220N | Turntable Set 40, natural | Steel, zinc-plated; POM, black | 474 |
| SA5220S | Turntable Set 40, black | Steel, zinc-plated black; POM, black | 474 |
| SA5210N | Turntable Set 80, natural | Steel, zinc-plated; POM, black | 800 |
| SA5210S | Turntable Set 80, black | Steel, zinc-plated black; POM, black | 800 |