

Steering Castors, rubber

Application:

For carts with heavy load.

Material: Housing: steel, zinc-plated

System: 40 - Slot 8

Temperature range (°C): -20° to +60°

Type: Castors

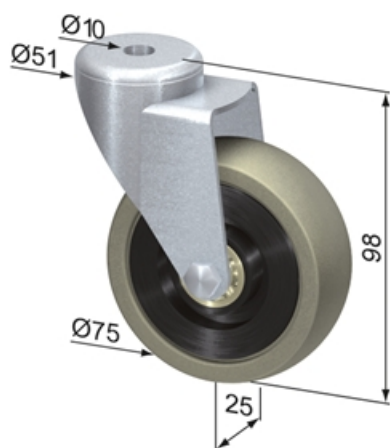

SF2300V

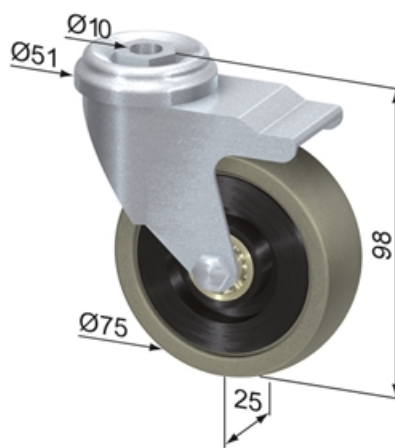

SF2302V

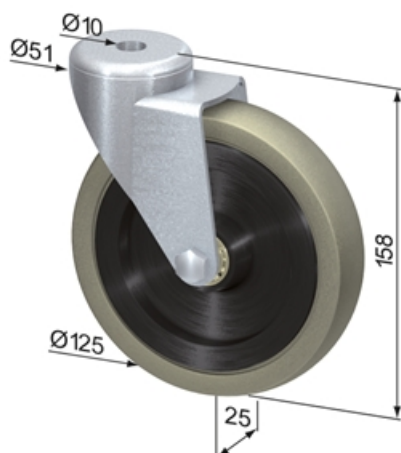

SF2310V

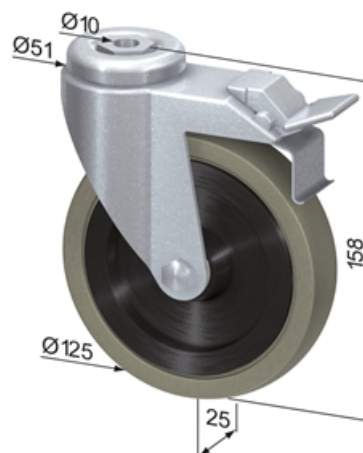

SF2312V

General Data

Designation	Description	System	Weight (g)	Max. Load (kg)
SF2300V	Steering Castor Ø 75, rubber	40 - Slot 8	330	60
SF2302V	Steering Castor Ø 75, rubber, fixable	40 - Slot 8	340	60
SF2310V	Steering Castor Ø 125, rubber	40 - Slot 8	1100	100
SF2312V	Steering Castor Ø 125, rubber, fixable	40 - Slot 8	1150	100