

Central Fastener 40 EL / EQ

Application:

All-purpose universal fastener. The twist-in anchor, with an anti-twist feature, can be fixed in the profile groove at any point. The anchor is held in position by a spring-loaded ball in the opposing profile t-slot.

Assembly:

Bore hole for the barrel housing: $\varnothing 12$ mm, 15 mm from profile end, 30 mm deep.

Bore for center hole on end of profile for anchor: $\varnothing 8.5$ mm, 25 mm deep.

System: 40 - Slot 8

Type: Fasteners

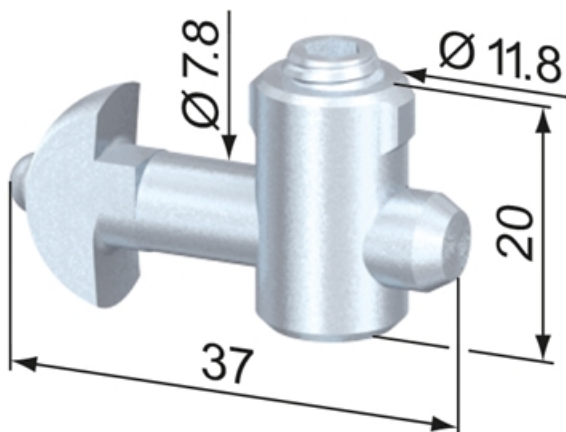

SV1011V

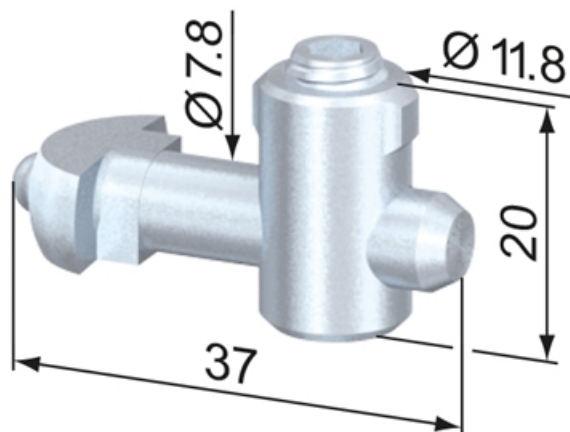

SV1021V

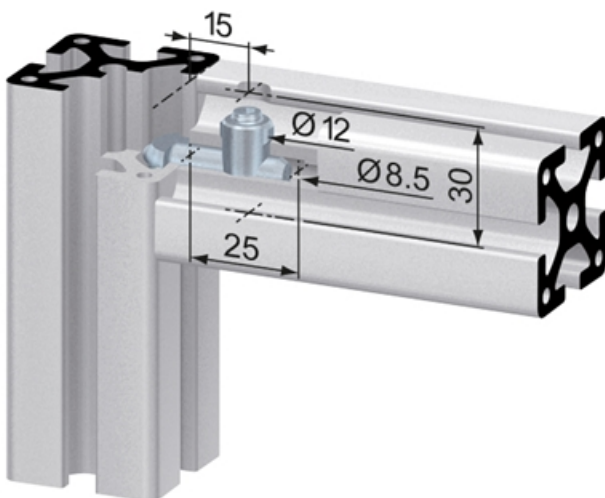

General Data

Designation	Description	System	Material	Weight (g)
SV1011V	Central Fastener 40 EL	40 - Slot 8	Steel, zinc-plated	26
SV1021V	Central Fastener 40 EQ	40 - Slot 8	Steel, zinc-plated	26