

## Light-Duty Metal Hinge – No Unhinging

For surface elements and aluminium profiles.

Optional adjustment by the oblong holes make this hinge fit for slot rows 5–8.

Once mounted, the surface element pivots by 180°.

Mounting material included:

3 M5 × 8 screws (ISO 7380),

1 M5 × 16 screw (DIN 903),

1 M5 nut (DIN 934),

1 5.3 washer (DIN 125) - black galvanised (RoHS-compliant)

**System:** 30 - Slot 6; 20 - Slot 5

**Type:** Hinges

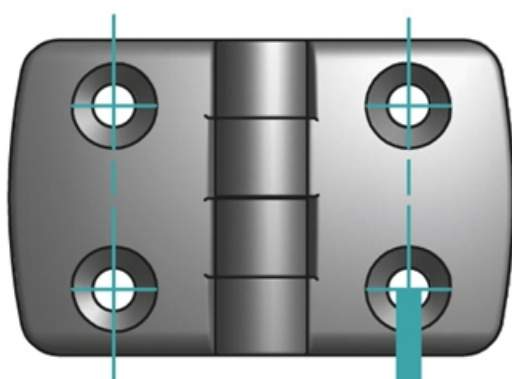
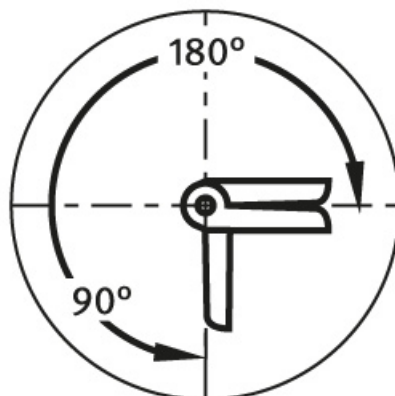

axial:  $F_{Amax}$

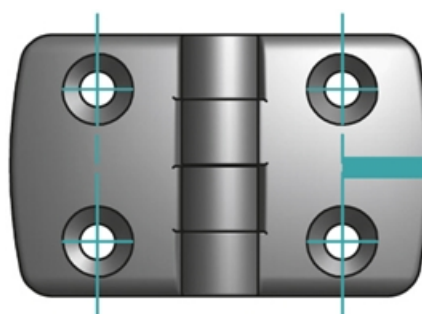

radial:

$F_{Rmax}$

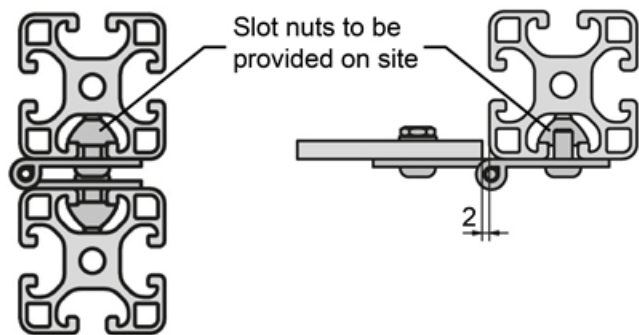

## General Data

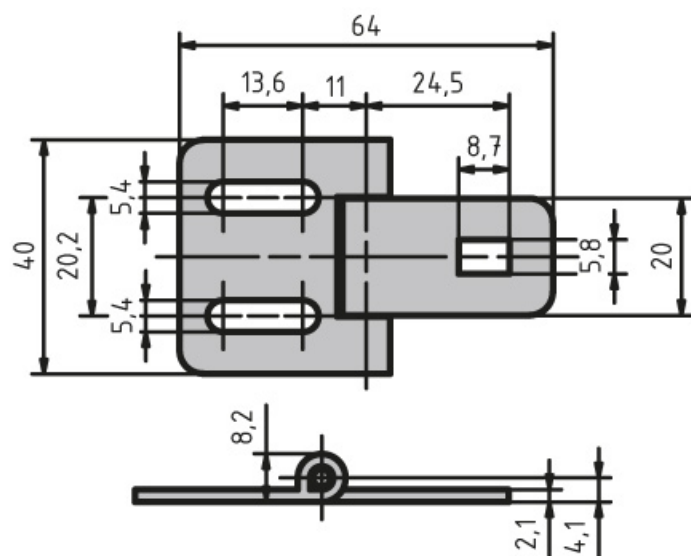

Designation	Material	F <sub>Amax</sub> (N)	F <sub>Rmax</sub> (N)
PZ1555	Black powder coated steel	250	75