

Plastic Hinge with Clamping Lever

For surface elements and aluminium profiles; can be locked at any point.

Material: Hinge & clamping lever: Plastic (PA), fibreglass-reinforced

Mechanism: Galvanised steel (RoHS-compliant)

Colour: Hinge: black powder coated

On-site mount: by M6 countersunk screw at the front

System: 30 - Slot 6

Type: Hinges

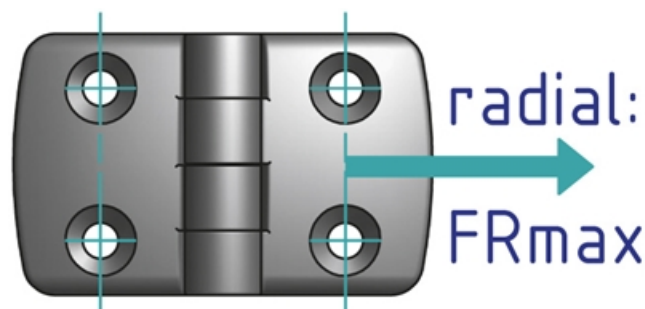
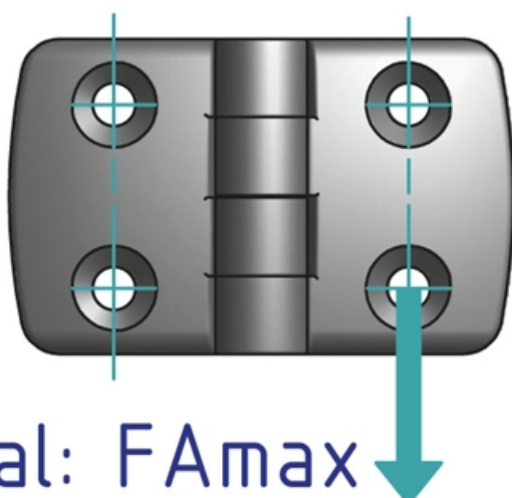
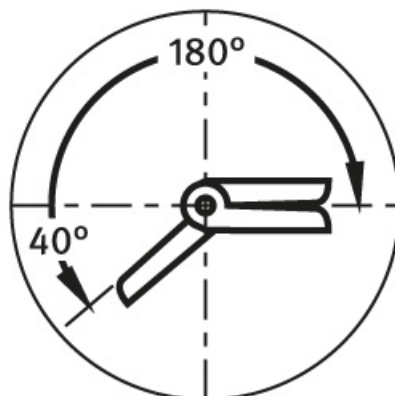

General Data

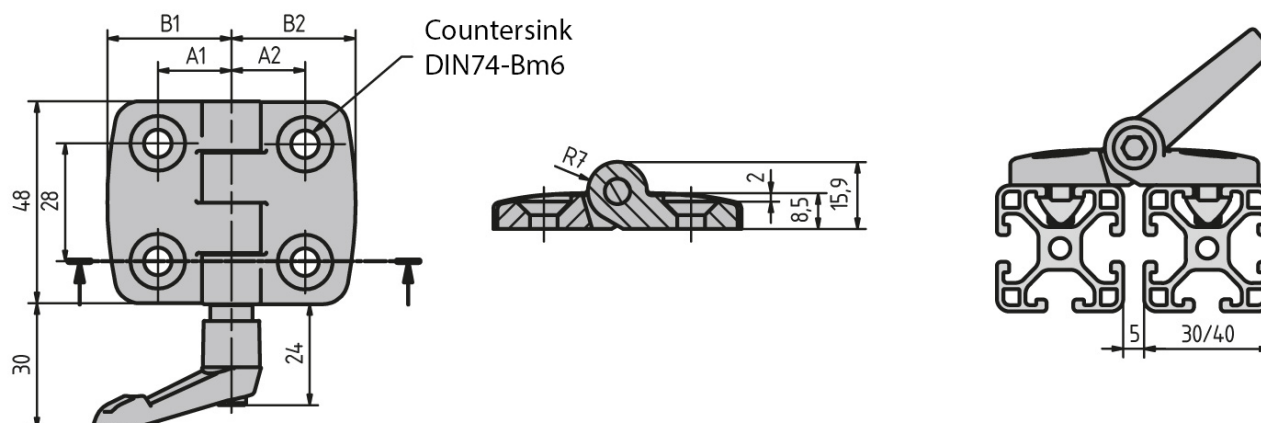

| Designation | Description | System | F _A max (N) | F _R max (N) | A1/A2 |
|-------------|---------------|-------------|------------------------|------------------------|-----------|
| PZ5026 | Hinge 30 × 30 | 30 - Slot 6 | 400 | 700 | 17.5/17.5 |

| Designation | B1/B2 |
|-------------|-----------|
| PZ5026 | 29.5/29.5 |