

Angle Joint

Easily links two aluminium profiles at a 45° angle using a M8 screw.

Note: To install the ESD-ready brackets, use a notched slot nut in order to make a conductive link.

System: 20 - Slot 5

Type: Angles Brackets and Corners; Fasteners

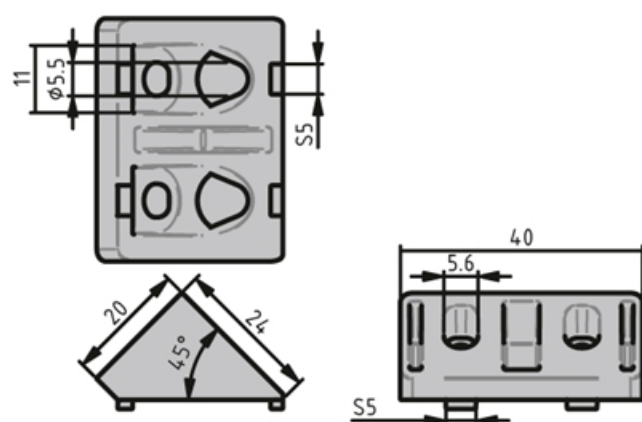
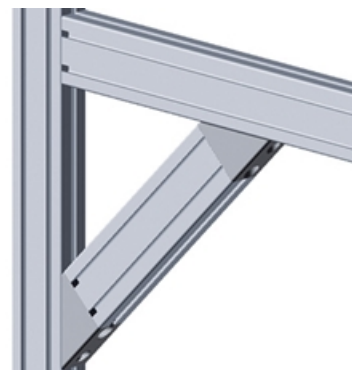

General Data

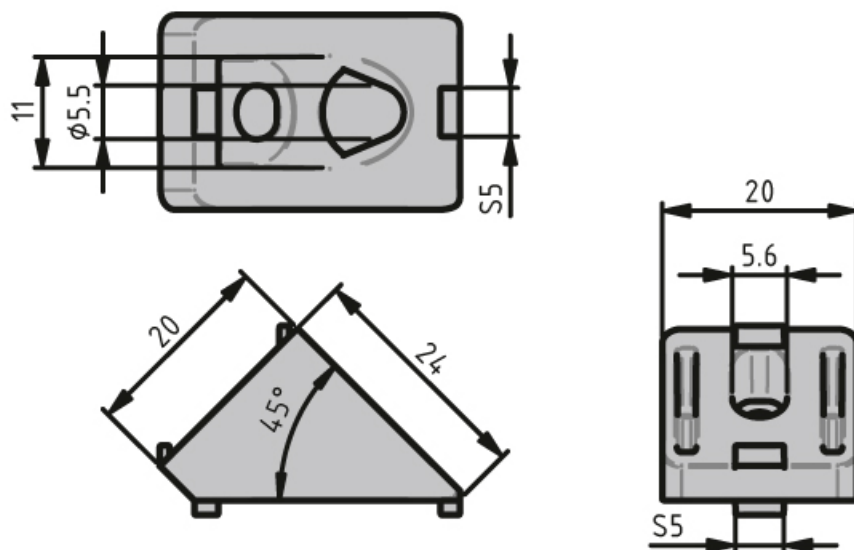

| Designation | Description | System | Material | ESD |
|-------------|-----------------------|-------------|----------------------------------|-----|
| PV1211 | Angle joint 20 45° | 20 - Slot 5 | Uncoated die-cast zinc | Yes |
| PV1212 | Angle joint 20 45° | 20 - Slot 5 | Aluminium coloured die-cast zinc | - |
| PV1213 | Angle joint 40/20 45° | 20 - Slot 5 | Uncoated die-cast zinc | Yes |
| PV1214 | Angle joint 40/20 45° | 20 - Slot 5 | Aluminium coloured die-cast zinc | - |