

## Couplings

For Mini Linear Units MGBS & MGTB.

Dimensions in mm.



## General Data

Designation	Compatible with	Rated Torque (Nm)	Max. Torque (Nm)	Tightening Torque of the Clamping Screw (Nm)	Moment of inertia per hub ( $10^{-3}$ kg m <sup>2</sup> )
EKL 2	VK 32	2	4	0.6	0.003
EKL 5	VK 45	9	18	2	0.02
EKL 10	VK 60	12.5	25	4	0.03

Designation	Weight (kg)	Speed standard (min <sup>-1</sup> )
EKL 2	0.008	15000
EKL 5	0.02	15000
EKL 10	0.05	13000

## Dimensions

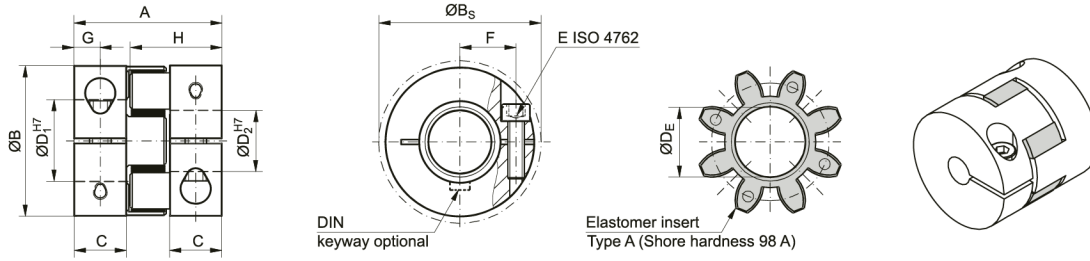

Designation	A	B	BS	C	D1	D2	DE	E	F
EKL 2	20	16	17	6	3	8	6.2	M2	5.5
EKL 5	26	25	25	8	4	12.7	10.2	M3	8
EKL 10	32	32	32	10.3	4	16	14.2	M4	10.5

Designation	G	H
EKL 2	3	12
EKL 5	4	16.7
EKL 10	5	20.7