

Back mount ABM

Dimensions in mm.

Mounting screws and nuts are included.

□ = Square cross section

Material: Stainless steel



General Data

| Designation | Description | Compatible with | Motor compatibility (type/size □ (mm)) | Material | Fmax (N) |
|----------------------|-------------|-----------------|--|-----------------|----------|
| ABM 25 - T1 - 108239 | ABM 25 - T1 | MCE 25 | Stepper / 28 | Stainless steel | F MCE |
| ABM 32 - T1 - 108237 | ABM 32 - T1 | MCE 32 | Stepper / 28 | Stainless steel | F MCE |
| ABM 32 - T2 - 108238 | ABM 32 - T2 | MCE 32 | Stepper / 42 | Stainless steel | F MCE |
| ABM 45 - T1 - 108235 | ABM 45 - T1 | MCE 45 | Stepper / 42 | Stainless steel | F MCE |
| ABM 45 - T2 - 105320 | ABM 45 - T2 | MCE 45 | Stepper / 56 | Stainless steel | F MCE |

| Designation | Mass (kg) | T (Nm) |
|----------------------|-----------|--------|
| ABM 25 - T1 - 108239 | 0.14 | 0.3 |
| ABM 32 - T1 - 108237 | 0.24 | 1.2 |
| ABM 32 - T2 - 108238 | 0.29 | 1.2 |
| ABM 45 - T1 - 108235 | 0.62 | 2.2 |
| ABM 45 - T2 - 105320 | 0.72 | 2.2 |

Dimensions

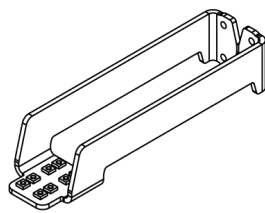

For fixed/simple support

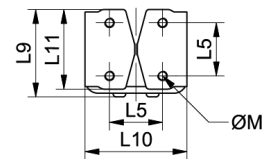
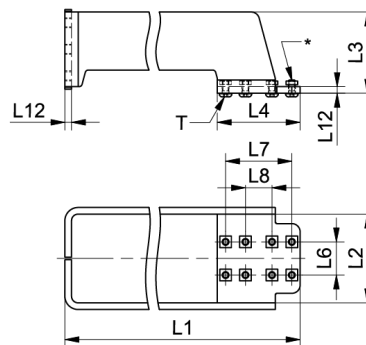
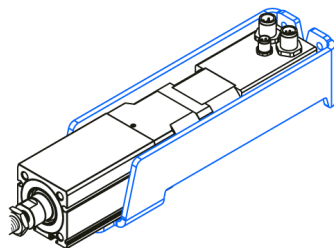
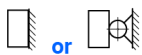

* MCE/MSCE mounting nuts and screws

| Designation | M | L1 | L2 | L3 | L4 | L5 | L6 | L7 | L8 |
|----------------------|----|-----|------|------|----|----|------|----|----|
| ABM 25 - T1 - 108239 | M4 | 165 | 30.5 | 27.5 | 35 | 18 | 13.5 | 28 | 12 |
| ABM 32 - T1 - 108237 | M5 | 170 | 38.5 | 35 | 40 | 22 | 13.5 | 28 | 12 |
| ABM 32 - T2 - 108238 | M5 | 200 | 46 | 35 | 40 | 22 | 13.5 | 28 | 12 |
| ABM 45 - T1 - 108235 | M6 | 210 | 53.5 | 49 | 50 | 32 | 20 | 40 | 16 |
| ABM 45 - T2 - 105320 | M6 | 245 | 64.9 | 49 | 50 | 32 | 20 | 40 | 16 |

| Designation | L9 | L10 | L11 | L12 |
|----------------------|------|------|-----|-----|
| ABM 25 - T1 - 108239 | 29.8 | 35.5 | 27 | 2.5 |
| ABM 32 - T1 - 108237 | 37.7 | 44.5 | 34 | 3 |
| ABM 32 - T2 - 108238 | 37.7 | 52 | 34 | 3 |
| ABM 45 - T1 - 108235 | 52.7 | 61.5 | 48 | 4 |
| ABM 45 - T2 - 105320 | 52.7 | 72.9 | 48 | 4 |